

# Z1105/...

Führungsbuchse, Gleitführung  
 Guide bush, slide way  
 Bague de guidage, guidage lisse

Mat.: C00 (Sintermetall/sintered metal/métal fritté)  
 ISO 9448-2/DIN 9831-1

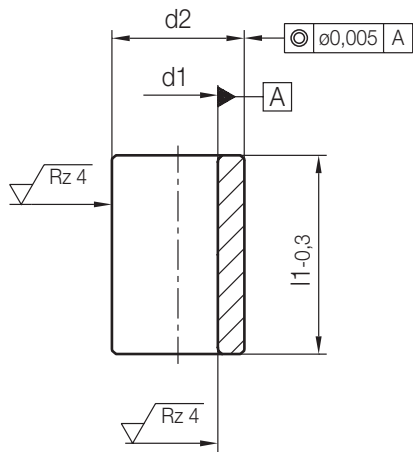

d2	Tol. d2	d1	l1	Nr./No.			
22	0 -0,004	11	23	Z1105/11x 23			
			30	30			
			37	37			
		12	0 -0,004	23	23	Z1105/12x 23	
					30	30	
					37	37	
				15	23	23	Z1105/15x 23
						30	30
						37	37
28	0 -0,005	16	23	Z1105/16x 23			
			30	30			
			37	37			
			47	47			
			60	60			
			77	77			
		19	23	23	Z1105/19x 23		
				30	30		
				37	37		
32	0 -0,005	20	23	Z1105/20x 23			
			30	30			
			37	37			

d2	Tol. d2	d1	l1	Nr./No.	
32	0 -0,005	20	47	Z1105/20x 47	
			60	60	
			77	77	
			40	24	23
30	30				
37	37				
47	47				
60	60				
77	77				
48	0 -0,005	25	23		Z1105/25x 23
			30	30	
			37	37	
			60	60	
		30	23	30	Z1105/30x 30
				37	37
				47	47
32	0 -0,005	30	60	60	
			77	77	
			95	95	
		32	23	30	Z1105/32x 30
				37	37
				47	47
48	0 -0,005	32	60	60	

# Z1105/...

Führungsbuchse, Gleitführung  
 Guide bush, slide way  
 Bague de guidage, guidage lisse

Mat.: C00 (Sintermetall/sintered metal/métal fritté)  
 ISO 9448-2/DIN 9831-1

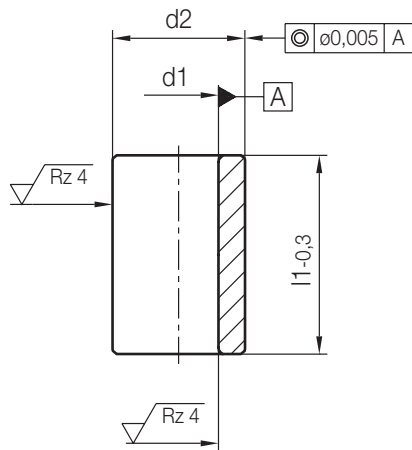
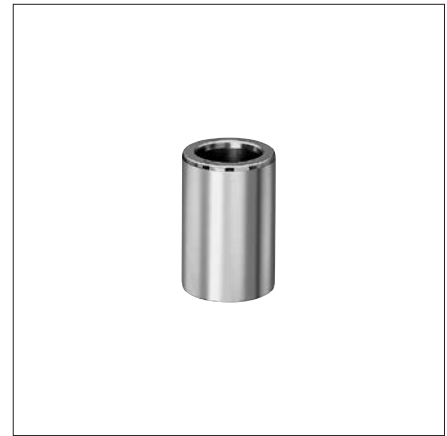

d2	Tol. d2	d1	l1	Nr./No.		
48	0 -0,005	32	77	Z1105/32x 77		
			95	95		
58	0 -0,007	38	30	Z1105/38x 30		
			37	37		
			47	47		
			60	60		
			77	77		
			95	95		
			120	120		
			40	30	Z1105/40x 30	
		37	37			
		47	47			
		60	60			
		70		48	37	Z1105/48x 37
47	47					
60	60					
77	77					
95	95					
120	120					
50				50	37	Z1105/50x 37
					47	47
					60	60

d2	Tol. d2	d1	l1	Nr./No.	
70	0 -0,007	50	77	Z1105/50x 77	
			95	95	
			120	120	
85	0 -0,007	60	60	Z1105/60x 60	
			77	77	
			95	95	
			120	120	
			63	60	Z1105/63x 60
		77	77		
		95	95		
		120	120		